



Product Overview





Our Story

MDS is an Irish manufacturing company specialising in equipment for aggregate handling, quarry, mining, construction and recycling sectors. We have over 25 years of experience in producing our own brand of heavy-duty rock trommels. MDS is widely known for our heavy duty track trommels. There is a range of models available in our product range to cater for the diverse customer needs. The designs are revolutionary and innovative with several added features which have allowed us to increase working life and productivity.

Our units are primarily used in applications like recovering rocks from overburden, cleaning off sticky clay from rocks, riprap/armour rocks, processing blasted rocks up to 32" (800mm) in size, recycling steel waste and incinerated bottom ash (IBA).

M412 Track Trommel	04
M413 Track Trommel	06
M515 Track Trommel	08
M518R Recycling Trommel	10
M615 Modular Trommel	12
M820 Track Trommel	14
M720R Recycling Trommel	16

MDS M412

The M412 Track Trommel is ideal for screening from light material to recycling heavy demolition waste. This machine can also operate in the quarry, cleaning dirty material up to 600mm (24") in height. It comes complete with the fold out stockpiling conveyors and ideal for moving around the quarry and from one site to the next.

TRANSPORT DIMENSIONS

LENGTH: 12,820mm (42ft)
 WIDTH: 2,500mm (8ft 2")
 HEIGHT: 3000m (9ft 8") | 3,423mm (11ft 2") w/Grid
 WEIGHT: 21.5 tonnes (23.7 US Tons)

DISCHARGE HEIGHTS

OVERSIZE: 2,326mm (7ft 6")
 FINES: 2,136mm (7ft)

OUTPUT

CAPACITY: 300 Tonnes per hour (330 US Tons PH)

OPTIONS

Drum Cleaner, Tipping Grid, Chasis Riser, Hopper Deflectors & Hopper Doors

Heavy Duty Drum
 Welded or Changable Screens
 4m (13ft 1") Long
 1250mm (4ft 1") Internal Diameter
 Drum Cleaner (Optional)

Hopper
 4 Cubic Metre Capacity (5.23yd³)
 Hydraulic Variable Speed Drive
 Speed of 8 Strokes Per Minute
 Wide Mouth Opening:
 3508x21097 (11'6" x 6'11")
 Heavy Duty Tipping Grid (Optional)

Push Feeder
 Hydraulic Push Feeder
 1018x3150 (3ft 4" x10ft 4")
 Variable Speed Drive

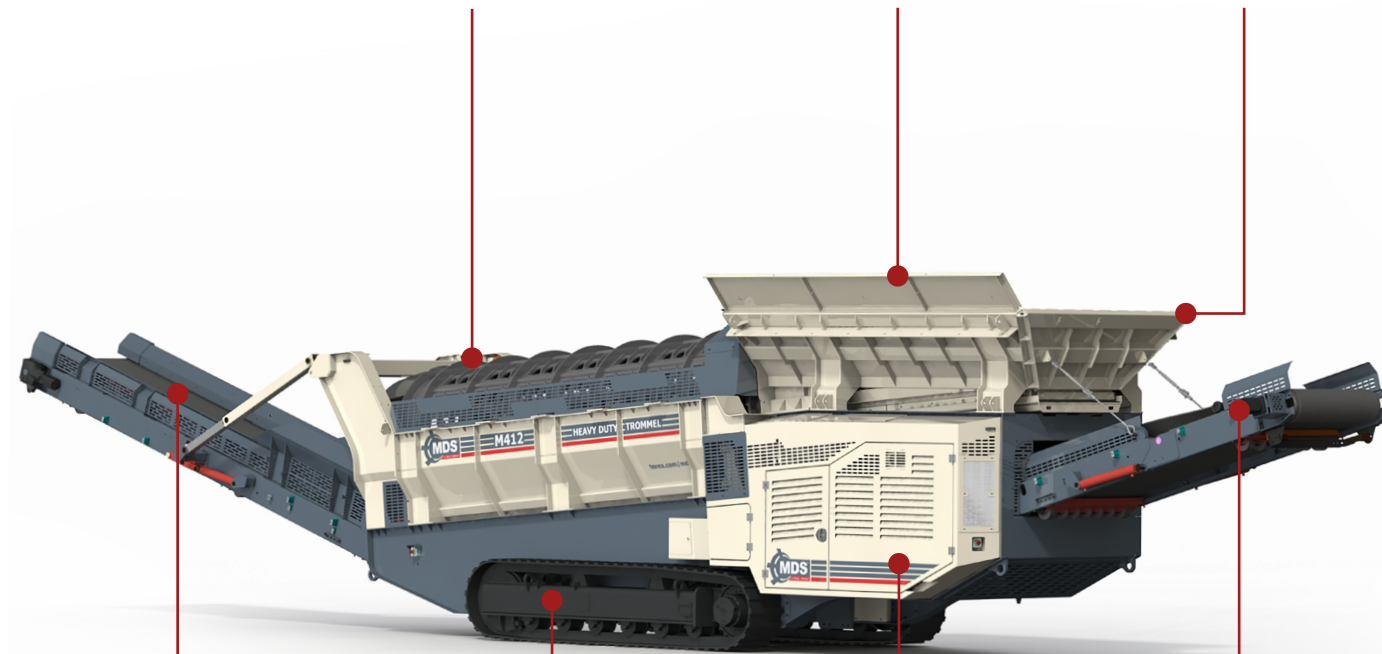

Oversize Conveyor
 Rocks up to 600mm (24")
 1000mm width (3ft 3")
 2.3m Output Height (7ft 6")
 Heavy Duty Belt
 Single Hub Hydraulic Drive

Tracks
 All terrain heavy duty tracks

Engine
 CAT 2.2 50kW (67HP) TIER 4 Engine
 Diesel Engine
 Hydraulic Power Unit
 Electronic Control System
 Sensors and Probes for Monitoring

Fines Conveyor
 Rocks Output up 150mm (6")
 1000m Width (3ft 3")
 2136mm Output Height (7ft)
 Single Hub Hydraulic Drive
 Heavy Duty Belt

Drums & Screens

The M412 drums can come in two configurations. Customers have the option of a drum frame with changeable screens or a fully welded drum. These configurations are shown to the right. Drum cleaners only work with fully welded drums.



1" (25mm)
 1.5" (38mm)
 2" (50mm)



3" (75mm)
 4" (100mm)
 5" (125mm)



6" (150mm)



MDS Trommels can come with an option to get changeable Screens on its drums or fully welded drums.

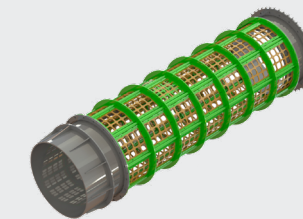

Drum Frame with Screens
 4m drum frame with screens
 Various screen sizes
 Easily changeable screens

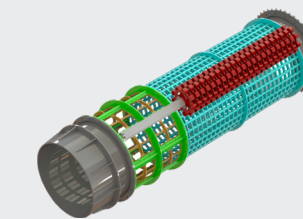

Welded + Screens
 2.9m welded drum
 75mm (3") to 150mm (6")
 Used with drum cleaner
 1.1m changeable screens up to 150mm (6")
 Allows to clean and control size

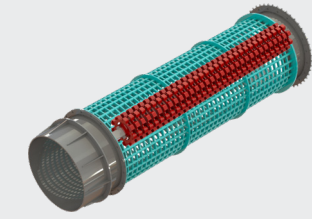

Fully Welded
 Full 4m welded drum
 Set up for dirty material



MDS M413

The M413 Track Trommel is ideal for screening light material to recycling demolition waste. This machine can also operate in the quarry, cleaning dirty material up to 600mm (24") in size. It comes complete with three fold out stock piling conveyors. It is compact in design and is easy to transport thus is ideal for moving around the quarry.

TRANSPORT DIMENSIONS

LENGTH: 13,405mm (43ft 11")
 WIDTH: 2,500mm (8ft 2")
 HEIGHT: 3,100mm (10ft 2") | 3,524mm (11ft 6") w/Grid
 WEIGHT: 29.5 tons

DISCHARGE HEIGHTS

OVERSIZE: 2,039mm (6ft 8")
 OVERSIZE: 1,986mm (6ft 6")
 FINES: 1,993mm (6ft 6")

OUTPUT

CAPACITY: 300 Tonnes per hour (330 US Tons PH)

OPTIONS

Drum Cleaner, Tipping Grid, Chasis Riser, Hopper Deflectors & Hopper Doors

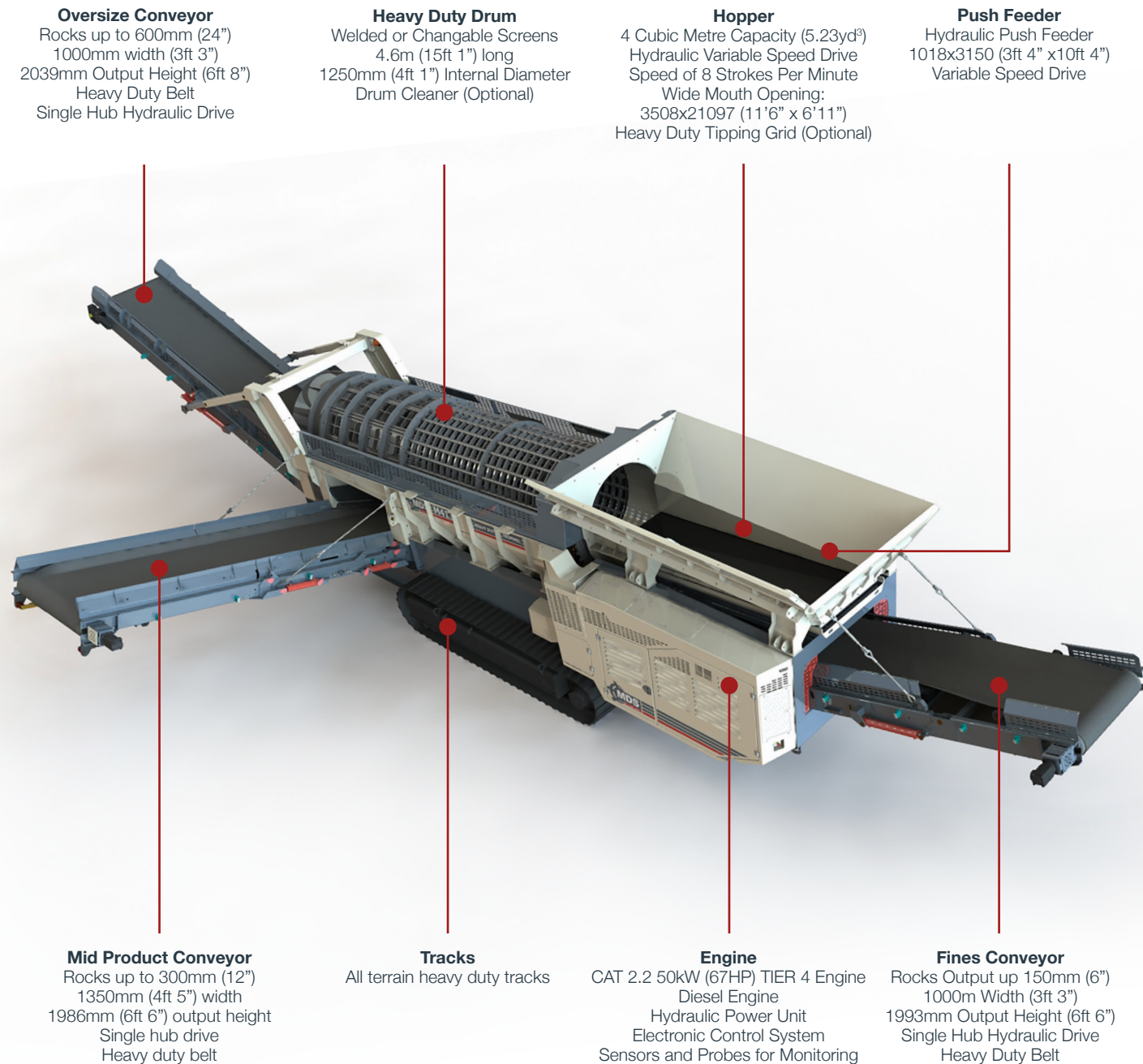

Drums & Screens

The M413 uses the same screens as M412 in its fines section. Mid-Product section uses a different style of screens. There are various screen sizes that can be chosen for the M413 Trommel which are shown.

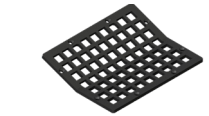

Fines
 1" (25mm)-6" (150mm)



Mid Product
 3" (75mm)-12" (300mm)



MDS M413 Trommels are made up of a drum with a 2.9m Fines section and 1.7m Mid Product Section. There are various combinations of drums that can be set up on the machine. There are either frames with changeable screens or fully welded drums. The exact configuration depends on the application and requirements of the customer. M412 screens fit in the fines section of the M413. However the Mid Product Screens have a different design. Drum Cleaners are only used with Fully Welded Drums in the fines section of the drum. These can be used with drums with openings of 75mm (3") to 150mm (6").

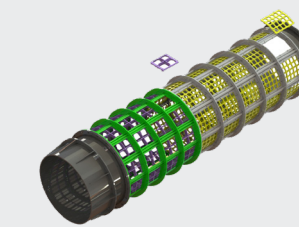

Standard Set Up - Both Screens

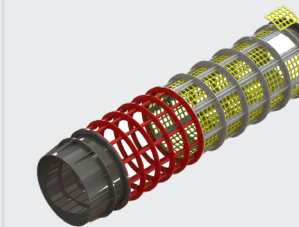

MP Welded, Fines Screens

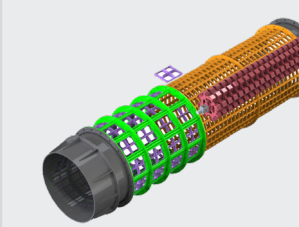

MP Screens, Fines Welded

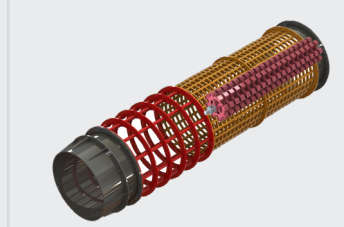

Both Welded Sections



MDS M515

The M515 Track Trommel is perfect for cleaning dirty material and can handle rocks up to 800mm (32") in size. It comes complete with fold out stockpiling conveyors and is ideal for moving around the quarry and from one site to the next.

TRANSPORT DIMENSIONS

LENGTH: 17,047mm (55ft 11")
 WIDTH: 2,980mm (9ft 9") | 3,179mm (10ft 5") w/Grid
 HEIGHT: 3,500mm (12ft 3") | 3,735mm (12ft 3") w/Grid
 WEIGHT: 48 tonnes (52.9 US Tons)

DISCHARGE HEIGHTS

OVERSIZE: 3,722mm (12ft 3")
 OVERSIZE: 3,510mm (11ft 6")
 FINES: 3,734mm (12ft 3")

OUTPUT

CAPACITY: 350-500 Tonnes per hour
 (385-550 US Tons PH)

OPTIONS

Drum Cleaner, Tipping Grid

Oversize Conveyor
 Rocks up to 800mm (32")
 3722mm (12ft 3") Output Height
 Single Hub Hydraulic Drive
 US Flex Dunlop Belt

Heavy Duty Drum
 Welded or Changeable Screens
 5.5m (18ft) long with 2 sections
 1500mm (4ft 11") Internal Diameter
 Drum Cleaner (Optional)

Hopper
 12 Cubic Metre Capacity (423ft³)
 Hydraulic Variable Speed Drive
 Speed of 8 Strokes Per Minute
 Wide Mouth Opening:
 Heavy Duty Tipping Grid (Optional)

Push Feeder
 Hydraulic Push Feeder
 Variable Speed Drive
 940x3810 Feeder Plate (3ft 1"x12ft 6")

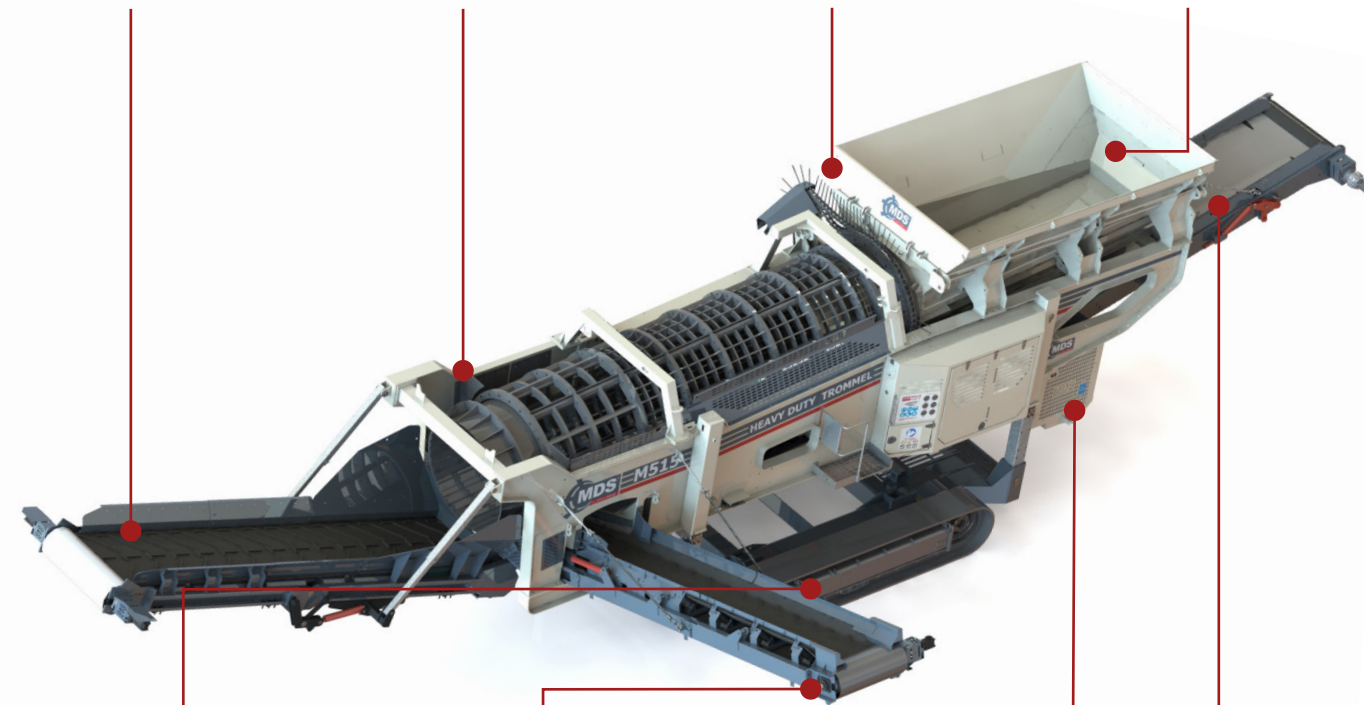

Tracks
 All terrain heavy duty high torque tracks
 Chassis raise and lowers on jack legs

Mid Product Conveyor
 Rocks up to 450mm (18")
 1000mm (3ft) width
 3510mm (11ft 6") output height
 Single hub drive
 Heavy duty belt

Engine
 CAT 4.4 96kW (129HP) Engine
 Diesel Engine
 Hydraulic Power Unit
 Electronic Control System
 Sensors and Probes for Monitoring

Fines Conveyor
 Output from 25-200mm (1-8")
 1200m Width (3ft 11")
 3734mm Output Height (12ft 3")
 Single Hub Hydraulic Drive
 Heavy Duty Belt

Drums & Screens

The M515 trommel is a versatile unit and can be used in different applications. MDS offers different drum options to cater for the needs of the customers. Drum frame with changeable screens and fully welded drums are available as options.



2 2/3"
(50/75mm)



2"
(50/75mm)



4"
(100mm)



5"
(125mm)



6"
(150mm)



8"
(200mm)



10"
(250mm)



12"
(300mm)

MDS 515 trommels are made up of a drum with a 4m fines section and 1.5m Mid Product Section. There are various combinations of drums that can be set up on the machine. These are either frames with changeable screens or fully welded drums. The exact configuration depends on the application and requirements of the customer.



Fines Drum Frame for Screens



Fines Fully Welded Drum

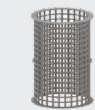

Fines 2.5m Welded Drum



Mid Product Frame for Screen



Mid Product Fully Welded Drum

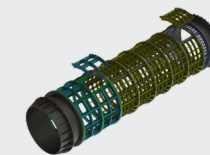

Standard Set Up - Both Screens

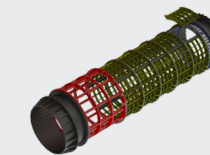

MP Welded, Fines Screens

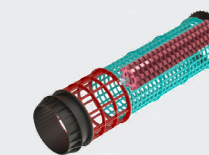

MP Screens, Fines Welded

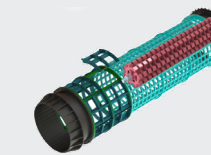

Both Welded Sections

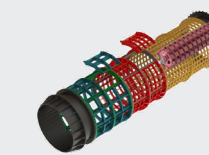

Both Welded Sections



MDS M518R

The M518R is a compact recycling trommel that is designed to be used in various applications. It is packed with many features and has several options that are quickly interchangeable. It can be fitted with 4 different styles of drums (5m long, 1.8m diameter). The main unit is design on tracks for easy mobility and a transport height just under 3170mm (10' 5").

TRANSPORT DIMENSIONS

LENGTH: 10,374mm (34ft)
 WIDTH: 2,500mm (8ft 2")
 HEIGHT: 3,180mm (10ft 4")
 WEIGHT: 17.9 tonnes (19.73 US Tons/ 39,463lbs)

OUTPUT

CAPACITY: Dependent on Application

Heavy Duty Drum
 1.8m (5ft 11") Diameter
 5m (16ft 5") Length
 Available with Brush Cleaner Attachment as standard
 Drum Roll Out for Easy Change

Hopper
 50m³ (6.54yd³) Capacity Hopper
 Heavy Duty US Flex Belt Conveyor
 Feed Opening: 3740x1954mm (12ft 3"x 6ft 5")
 920mm (3ft) Belt Width
 Tipping Grid Option Available



Track Base
 Standard Track Base
 Lower Transport Height
 Easy to Move Around Site

Engine
 CAT 2.2 50kW (67HP) Tier 4 Diesel
 Hydraulic Power Unit
 Electronic Control System
 Sensors and Probes for Monitoring

Drum Types



Square Punch Plate
 5mm to 100mm (13/64"-4") Openings

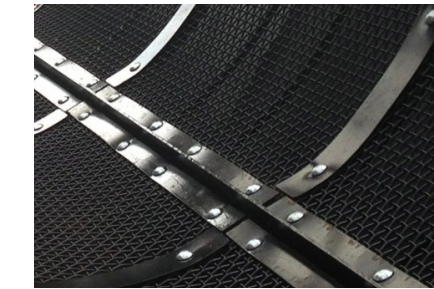

Wired Mesh
 1mm to 20mm (3/64"-3/4") Openings



MDS M615

The M615 Modular Trommel is capable of screening material at the rate of approximately 500 tons per hour with a max rock size of 800mm (32"). It is ideal for use in cleaning dirty rock or screening blasted material. With 3 possible configurations, our modular trommel covers many applications. The M615 comes with 4 splits as standard.

TRANSPORT DIMENSIONS

LENGTH: 12,188mm (40ft)
 WIDTH: 2,556mm (8ft 5")
 HEIGHT: 3,036mm (9ft 12")
 WEIGHT: 45 tonnes (38.6 US Tons)

DISCHARGE HEIGHTS

OVERSIZE: 12,478 (40ft 11")
 OVERSIZE: 6,458 (21ft 2")

OUTPUT

CAPACITY: 500 Tonnes per hour
 (550 US Tons PH)

Heavy Duty Drum
 Max rock size 800mm (32")
 1.5m (4ft 11") Drum Diameter
 6m (19ft 8") Drum Length
 Drum Cleaner (Optional)
 4 Outputs (5 with Grid)

Hopper
 Hydraulic Push Feeder
 Capacity of 15m³ (530ft³)
 970mm (3ft 2") plate width
 2580x4665mm feed opening (8ft 6"-15ft 4")
 Tipping Grid Available

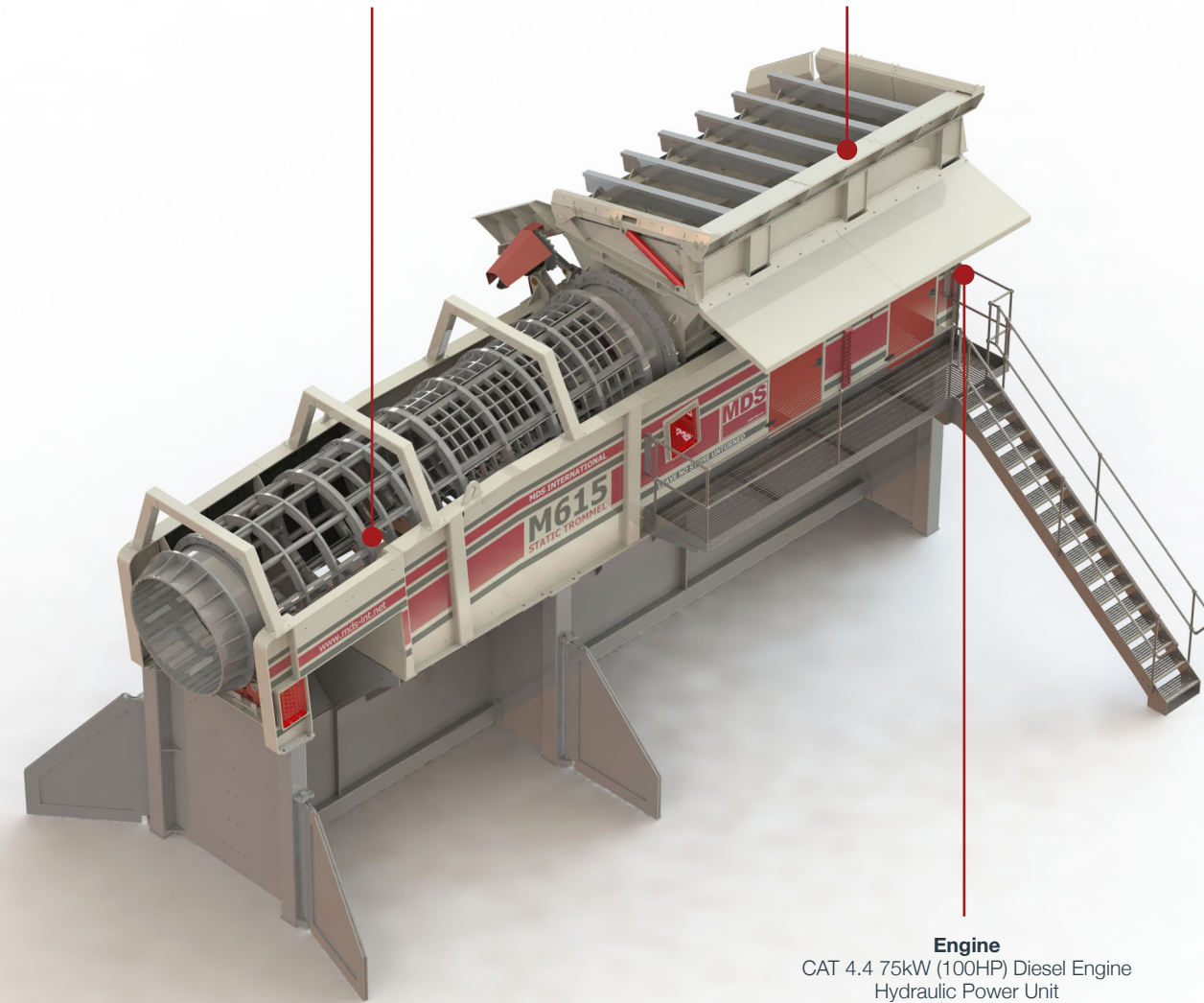

Engine
 CAT 4.4 75kW (100HP) Diesel Engine
 Hydraulic Power Unit
 Electronic Control System
 Sensors and Probes for Monitoring

Drums & Screens

The M615 trommel is a versatile unit and can be used in different applications. MDS offers different drum options to cater for the needs of the customers. Drum frame with changeable screens and fully welded drums are available as options. It uses the same screens as the M515.



2 3/8"
(50/75mm)



2 3/8"
(50/75mm)



4"
(100mm)



5"
(125mm)



6"
(150mm)



8"
(200mm)



10"
(250mm)



12"
(300mm)



MDS M820

The M820 is the largest track trommel in the world. It is a heavy duty rock trommel, capable of screening rocks up to 1m (40") in size at approximately 750 tons per hour. It is ideal for use in cleaning dirty rock or screening blasted material. With three possible configurations, our modular trommel covers many applications. The M820 comes with 3 or 4 splits.

TRANSPORT DIMENSIONS

LENGTH: 14,923mm (49ft)
 WIDTH: 3,647mm (12ft)
 HEIGHT: 3,826mm (12ft 5")
 WEIGHT: 80 tonnes (88 US Tons)
 WEIGHT WITH TRACKS: 200 tonnes (200 US Tons)

DISCHARGE HEIGHTS

OVERSIZE: 22,598 (74ft 2")
 OVERSIZE: 25,248 (82ft 10")

OUTPUT

CAPACITY: 720 Tonnes per hour
 (826 US Tons PH)

Heavy Duty Drum
 Max Rock Size 1m (40")
 Perfect for Cleaning Dirty Material
 2m (6ft 7") Diameter
 8m (26ft 3") Length
 3 or 4 Outputs (50 to 600mm/2-24")
 5 with Tipping Grid

Hopper
 Hydraulic Push Feeder
 Variable Speed Drive
 Capacity of 70m³ (2472ft³)
 1200mm (3ft 11") Plate Width
 4100x4875mm Feed Opening (13ft5"x16ft)
 Extensions Wings for 40 Ton Dump

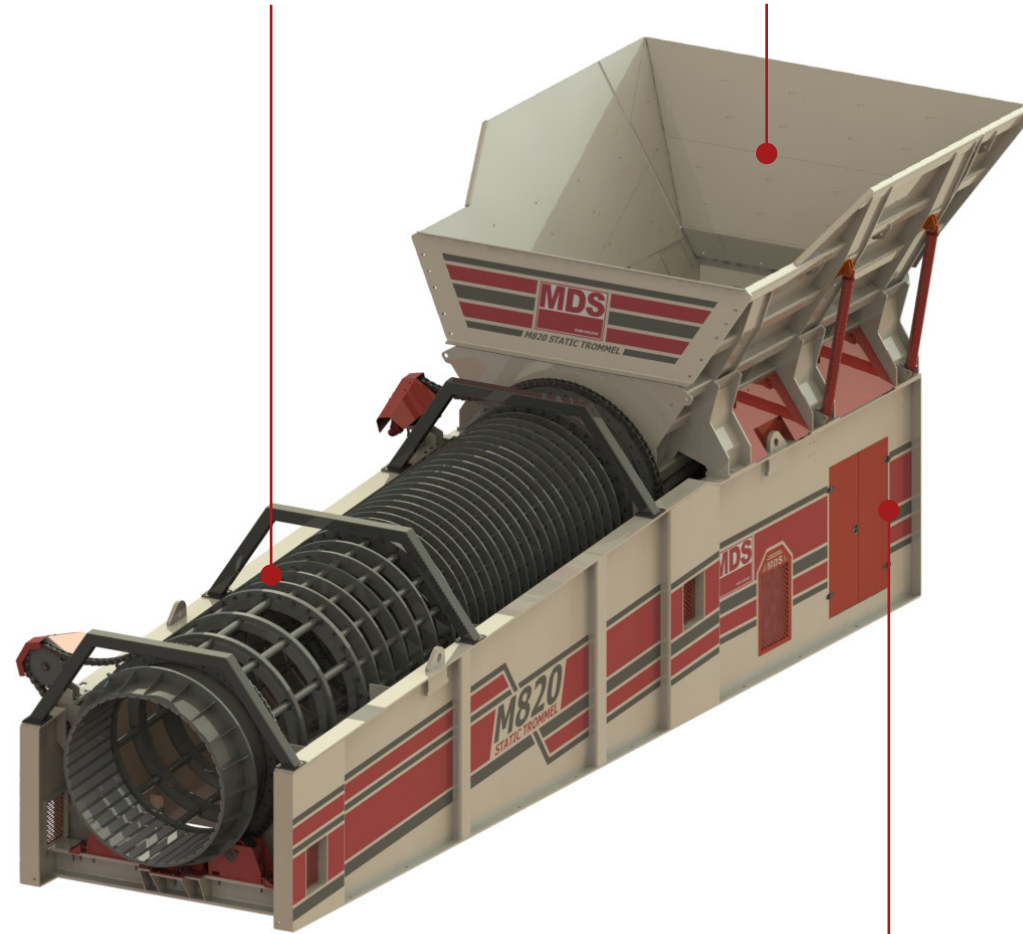

Engine
 2x 90kW (120HP) Electric Motors or CAT 7.1 Engine
 Electronic Control System
 Speed Control on Drum & Feeder
 Auto Drum & Feeder Reverse
 Remote Controlled Start/Stop



MDS M720R

The M720 Recycling trommel is ideal for screening heavy materials from steel to demolition waste and recycling in general. It can be used in a quarry, recycling or construction setting. It can handle material up to 750mm and it great for scalping, cleaning overburden and screening materials into different size streams. It is equipped with 2m (6ft 6") diameter & 7m (22ft 11") long drum.

TRANSPORT DIMENSIONS

LENGTH: 11,922mm (39ft 1")
 WIDTH: 3,500mm (11ft 6")
 HEIGHT: 3,222mm (10ft 7")
 WEIGHT: 34 tonnes (37 US Tons)

WORKING DIMENSIONS

LENGTH: 11,871mm (38ft 11")
 WIDTH: 3,500mm (11ft 6")
 HEIGHT: 6,512mm (21ft 4")

OUTPUT

CAPACITY: 800 Tonnes per hour
 (882 US Tons PH)

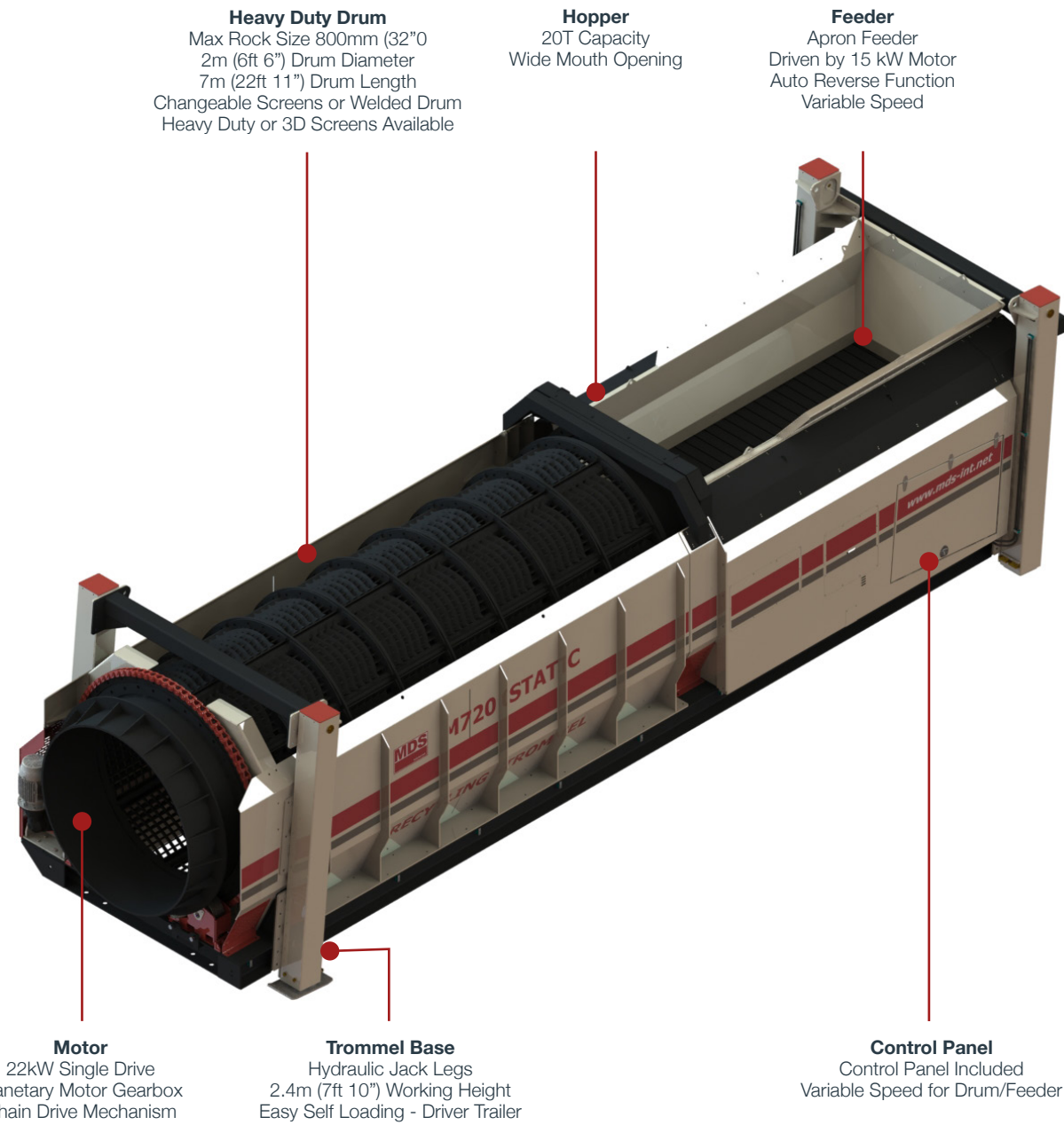





Drummond, Magheracloone
A81 TE82, Carrickmacross
Co.Monaghan, Ireland

+353 42 966 7899
mds.info@terex.com
terex.com/mds

